

### EXTERIOR VIEW

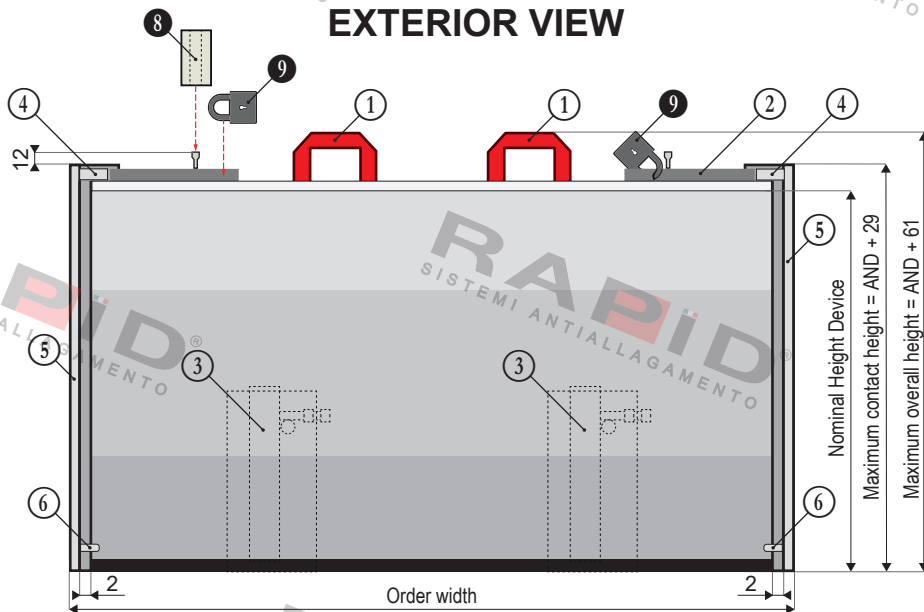

### SIDE VIEW

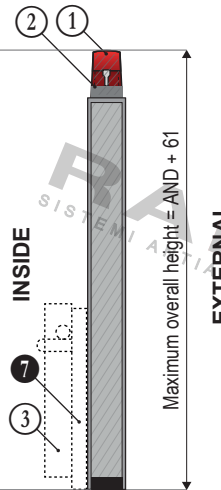

### PLACEMENT

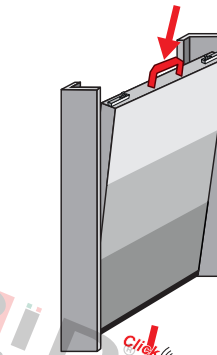

1) Tilt the panel as little as possible and then insert it between the pawls and the inner side of the 30 mm L-profiles until it rests on the underside

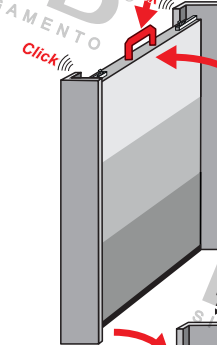

2) Press the handle both downwards and inwards until the locking **CLICK**, then press the bolt knobs to drive the square pegs into the grooves of the pushers. Insert the vertical latch bolt tip, if present, into the brass spring-loaded well.

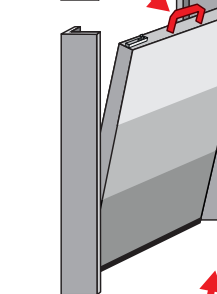

3) Raise the vertical latch (if present) and fully retract the square posts into the horizontal bolt sheaths, then press the handle downwards and rotate it slightly outwards until the panel is unlocked.

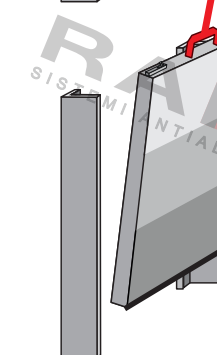

4) Remove the panel by approx. 30 mm, slide it upwards by at least 30 mm and store the panel properly.

### PLANT

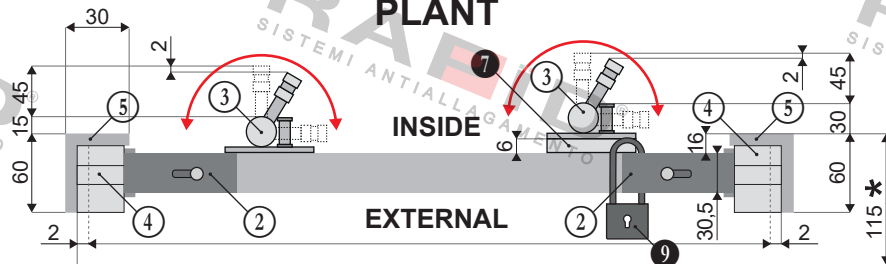

### Measures in mm

- ① Variable number of internal or external carrying and operating handles.
- ② Horizontal bolt lock.
- ③ Possible vertical gate latch door (see table: vertical latches).
- ④ Pressor.
- ⑤ L-profile 60x30.
- ⑥ Latch.
- ⑦ Possible displacement thickness Latch if a profile is provided for the underside.
- ⑧ Ergonomic handle.
- ⑨ Padlock.

\* = Minimum size for inserting and interlocking the device.

- Up to 2 years warranty on seals (for spare parts see page 'Spare Parts Table')